



Holmesfield Road, Great Barr
Birmingham, B42 2DJ

£200,000

Great Barr

£200,000



Holmesfield Road is an immaculately kept three bedroom semi detached property located on the Beeches Estate within Great Barr, the property benefits from local shops and good schools within walking distance.

The property is approached via a well maintained front garden and steps up into the property.

Entry is through a secure porch, into a welcoming hallway. The living room offers a large front bay window, central fireplace with surround and hearth. The kitchen/diner spans the rear of the property and offers a traditional kitchen, with predominately base units. The space also allows for a family dining table.

To the first floor, there are three bedrooms, two comfortable doubles and a smaller third bedroom. The family bathroom offers a modern white suite with bathtub and overhead shower, hand wash basin and low level W.C.

Externally, there is a good size and beautifully maintained rear garden which offers a slabbed patio area, then a lawn with flower/shrub borders.

Viewing is highly recommended at your earliest convenience on this wonderfully kept family home.





Agent's Note:

Every care has been taken with the preparation of these Sales Particulars but they are for general guidance only and complete accuracy cannot be guaranteed. If there is any point which is of particular importance, professional verification should be sought. The mention of any fixtures, fittings and/or appliances does not imply they are in full efficient working order as they have not been tested. All dimensions are approximate. Photographs are reproduced for general information and it cannot be inferred that any item shown is included in the sale. These Sales Particulars do not constitute a contract or part of a contract.
Came on the market:

Property Specification

THREE BEDROOM SEMI DETACHED
BEECHES ESTATE
BEAUTIFULLY MAINTAINED THROUGHOUT
KITCHEN/DINER
SOUTH FACING GARDEN

Entrance Hallway

Living Room
13' 9" x 9' 10" (4.2m x 3.0m)

Kitchen/ Diner
9' 10" x 15' 9" (3.0m x 4.8m)

Landing

Bedroom One
10' 6" x 9' 6" (3.2m x 2.9m)

Bedroom Two
12' 10" x 8' 10" (3.9m x 2.7m)

Bedroom Three
8' 10" x 6' 7" (2.7m max x 2.0m max)

Bathroom
6' 11" x 5' 11" (2.1m x 1.8m)

Viewer's Note:

Services connected: mains electricity, gas, water and drainage
Council tax band: B
Tenure: Leasehold - 950 years unexpired
Ground Rent: £9 per annum

Floor Plan

This floor plan is not drawn to scale and is for illustration purposes only

Energy Efficiency Rating

Ground Floor

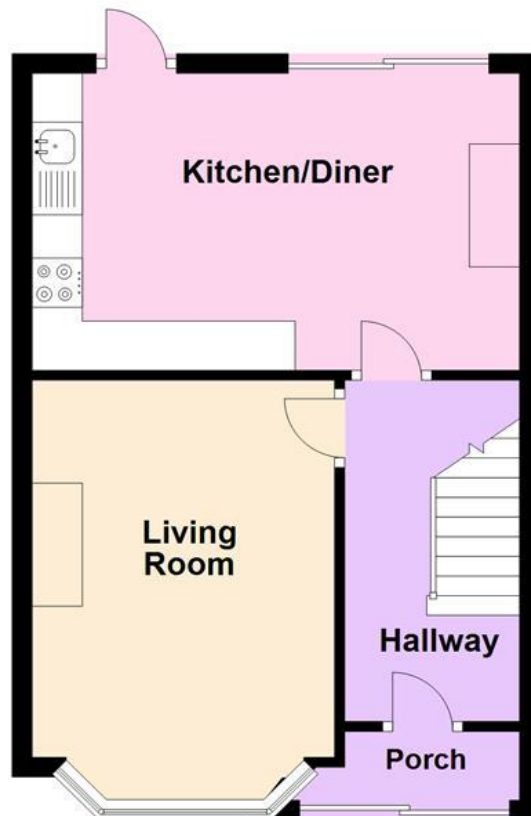

First Floor

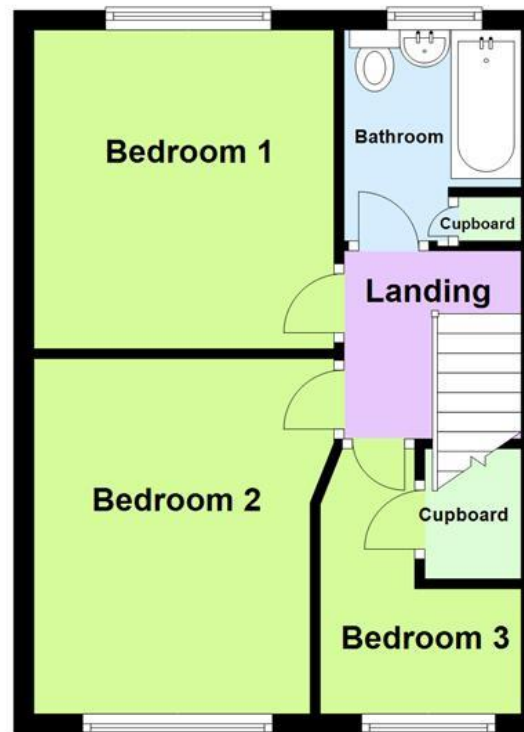

Map Location

